



Balsam Minor Boundary Line Adjustment and Easement

December 10, 2020

Background

Location – south of Tahoe City



Background

- House partially on Conservancy-owned parcel
- Driveway is outside of existing easement



Project Description

Minor Boundary Line Adjustment

- Exchange of ~1,081 Square Feet
- Equal monetary value, size, land capability, and ecological quality

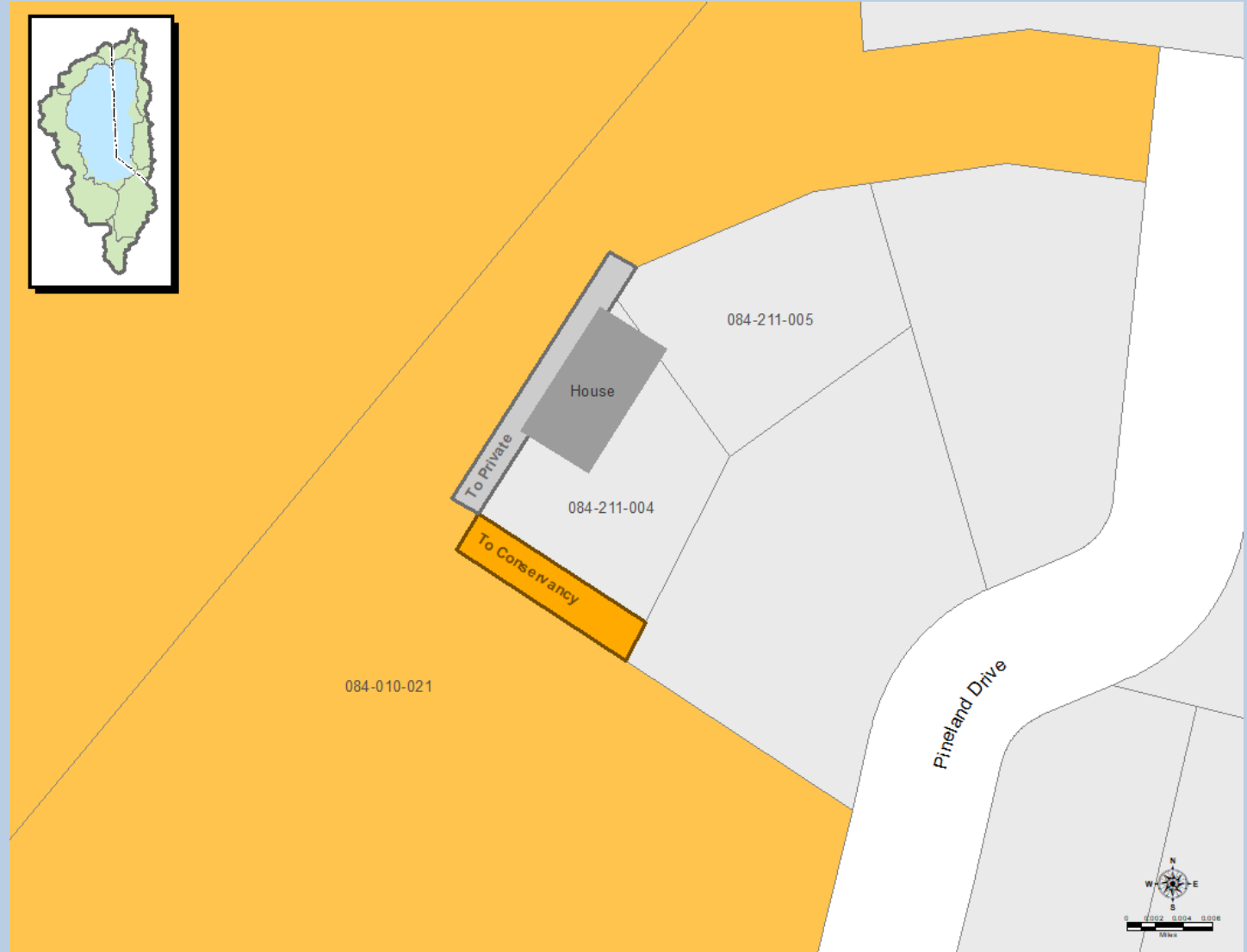

Project Description

Easement

- No environmental impact

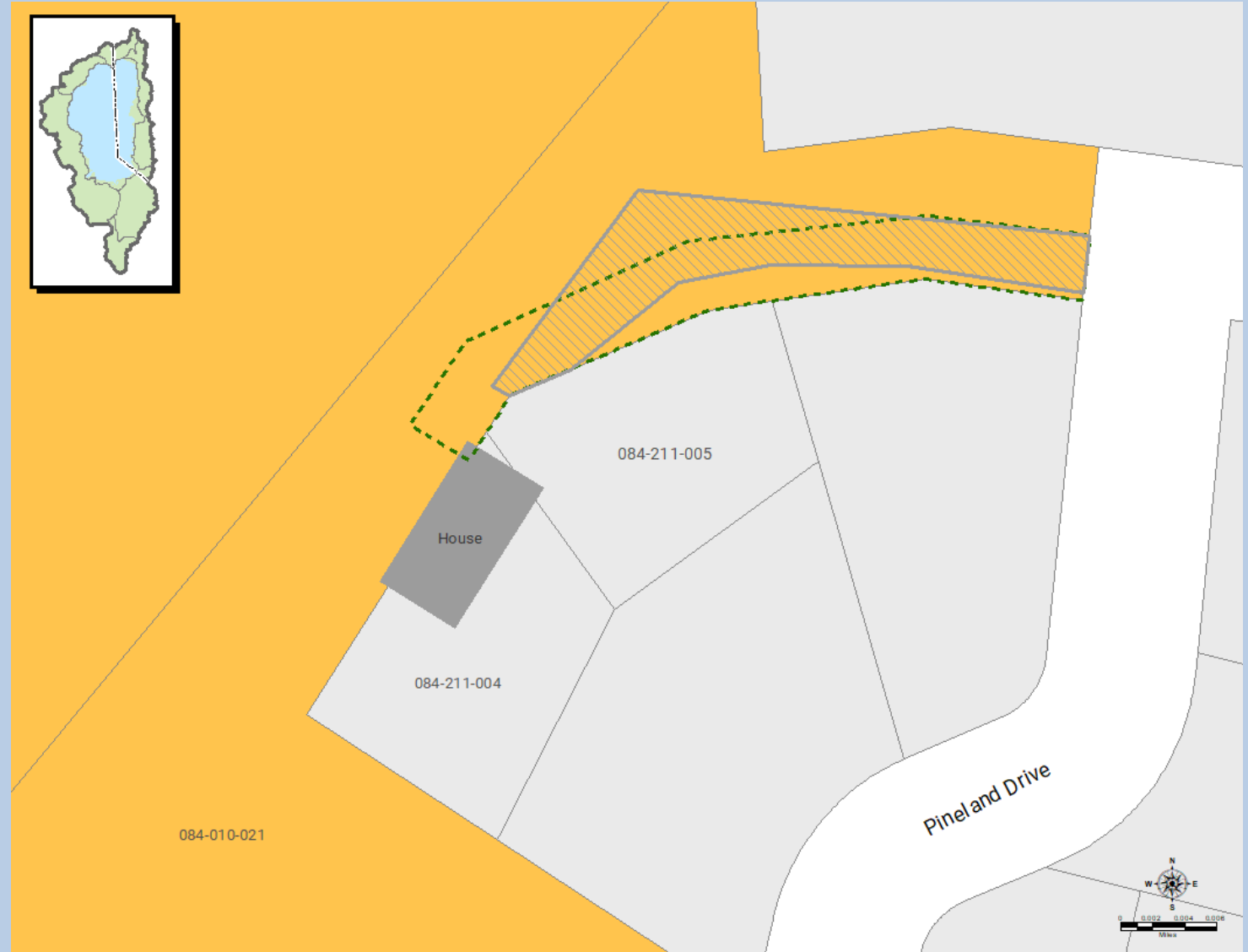

Next Steps

Schedule

- Homeowner driven

Budget

- Homeowner pays for key documents and survey





Recommendation

Adopt Resolution 20-12-05 authorizing the execution of a minor boundary line adjustment between a California Tahoe Conservancy-owned parcel (Placer County Assessment Number (AN) 084-010-021) and a privately owned parcel (Placer County AN 084-211-004), and the conveyance of an easement on the Conservancy-owned parcel.