

APPENDIX C

Schematic Plans

SCHEMATIC DESIGN PLANS
& DETAILS
NOT FOR CONSTRUCTION

CALIFORNIA DEPARTMENT OF GENERAL SERVICES
AND
CALIFORNIA TAHOE CONSERVANCY
UPPER TRUCKEE RIVER AND MARSH
RESTORATION PROJECT



UPPER TRUCKEE RIVER
AND MARSH RESTORATION
PROJECT

E.I.P. # 560



870 Emerald Bay Road, Suite 400
South Lake Tahoe, CA 96150
Tel: 530.543.5100 Fax: 530.543.5150



295 Highway 50, suite 1
Zephyr Cove, NV 89448
Tel: 775.588.9069

TITLE SHEET

i

REVISIONS

#	description	date

scale: AS SHOWN

job no.: 00110066.04

drawn by: MC

checked by: CM

sheet no.: i

sheet 1 of 45

date: 01/10/13

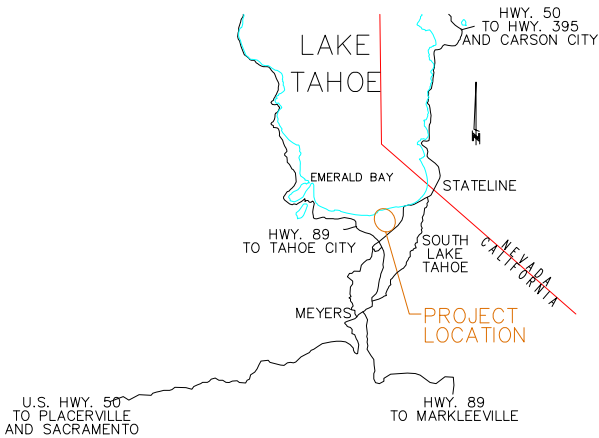

VICINITY MAP

N.T.S



LOCATION MAP

SOUTH LAKE TAHOE, EL DORADO COUNTY, CA
SCALE 1" = 1000'



SHEET INDEX:

TITLE	SHEET NO.
TITLE SHEET	I
INDEX SHEET	II
CONSTRUCTION PHASING	III
PLAN VIEW (ALTERNATIVE 1)	S1
UPSTREAM REACH PLAN (ALTERNATIVE 1)	C1
MID-MARSH PLAN (ALTERNATIVE 1)	C2
DOWNSTREAM REACH PLAN (ALTERNATIVE 1)	C3
DOWNSTREAM REACH CROSS-SECTIONS (ALTERNATIVE 1)	C4
BARTON BEACH BOARDWALK (ALTERNATIVE 1)	C5
PLAN VIEW (ALTERNATIVE 2)	S2
UPSTREAM REACH PLAN (ALTERNATIVE 2)	C6
MID-MARSH PLAN (ALTERNATIVE 2)	C7
DOWNSTREAM REACH PLAN (ALTERNATIVE 2)	C8
DOWNSTREAM REACH CROSS-SECTIONS (ALTERNATIVE 2)	C9
PLAN VIEW (ALTERNATIVE 3)	S3
UPSTREAM REACH PLAN (ALTERNATIVE 3)	C10
MID-MARSH PLAN SHEET A (ALTERNATIVE 3)	C11
MID-MARSH PLAN SHEET B (ALTERNATIVE 3)	C12
DOWNSTREAM REACH PLAN (ALTERNATIVE 3)	C13
DOWNSTREAM REACH CROSS-SECTIONS (ALTERNATIVE 3)	C14
PLAN VIEW (ALTERNATIVE 4)	S4
UPSTREAM REACH PLAN (ALTERNATIVE 4)	C15
MID-MARSH PLAN (ALTERNATIVE 4)	C16
DOWNSTREAM REACH PLAN (ALTERNATIVE 4)	C17
DOWNSTREAM REACH CROSS-SECTIONS (ALTERNATIVE 4)	C18
DETAILS	D1
DETAILS	D2
DETAILS	D3
DETAILS	D4
DETAILS	D5
DETAILS	D6
DETAILS	D7
DETAILS	D8
DETAILS	D9
BIKE TRAIL	L1
FOOT TRAIL	L2
VIEW POINT	L3
BRIDGE	L4
BOARDWALK	L5
OBSERVATION AREA TYPE 1 - PUBLIC ACCESS	L6
OBSERVATION AREA TYPE 2 - HABITAT PROTECTION	L7
FISHING PLATFORM	L8
EXISTING RIVER ACCESS STABILIZATION	L9
SELF-SERVICE VISITORS CENTER	L10
REVEGETATION SECTION AND PLANT LIST	L11

- GENERAL NOTES
1. ALL IMPROVEMENTS SHALL BE ACCOMPLISHED UNDER THE APPROVAL, INSPECTION, AND TO THE SATISFACTION OF THE CALIFORNIA DEPARTMENT OF GENERAL SERVICES (DGS). IMPROVEMENT CONSTRUCTION SHALL COMPLY WITH THESE PLANS AND THE 2010 CALTRANS STANDARD PLANS FOR CONSTRUCTION OF LOCAL STREETS AND ROADS, UNLESS NOTED OTHERWISE. ALL REFERENCES TO THE "STANDARD SPECIFICATIONS" SHALL MEAN THE STATE OF CALIFORNIA, DEPARTMENT OF TRANSPORTATION (CALTRANS) STANDARD SPECIFICATIONS FOR CONSTRUCTION OF LOCAL STREETS AND ROADS, 2010, INCLUDING THE AMENDMENTS TO THE 2010 STANDARD SPECIFICATIONS. CONSTRUCTION NOT SPECIFIED ON THESE PLANS OR IN SPECIFIC CITY OF SOUTH LAKE TAHOE (CSLT) ORDINANCES SHALL CONFORM TO THE REQUIREMENTS OF THE STANDARD SPECIFICATIONS. THE CONTRACTOR IS OBLIGATED TO BE FAMILIAR WITH APPLICABLE SECTIONS OF THE STANDARD SPECIFICATIONS NOT DISCUSSED IN THE GENERAL NOTES. THE CONTRACT SPECIAL PROVISIONS SHALL SUPERSEDE THOSE OF THE STANDARD SPECIFICATIONS WHERE DISCREPANCIES OCCUR.

2. CONSTRUCTION HOURS SHALL BE WEEKDAYS BETWEEN 8:00 A.M. AND 6:30 P.M. UNLESS PRIOR APPROVAL IS RECEIVED FROM THE DGS.

3. THE LOCATIONS AND EXTENT OF EXISTING UNDERGROUND UTILITIES IN THE WORK AREA AS SHOWN ARE APPROXIMATE AND ARE NOT NECESSARILY COMPLETE. A REASONABLE EFFORT HAS BEEN MADE TO LOCATE AND DELINEATE EXISTING UTILITIES BASED UPON AVAILABLE RECORDS. THE CONTRACTOR SHALL DETERMINE THE TYPE, LOCATION, SIZE, AND/OR DEPTH OF THE EXISTING UTILITIES WITHIN THE WORK AREA BEFORE COMMENCING WORK. THE CONTRACTOR OR ANY SUBCONTRACTOR FOR THIS CONTRACT SHALL BE FULLY RESPONSIBLE FOR ANY AND ALL DAMAGES WHICH MIGHT BE OCCASIONED BY THE FAILURE TO EXACTLY LOCATE AND PRESERVE ANY AND ALL UNDERGROUND UTILITIES. THE CONTRACTOR SHALL CONTACT UNDERGROUND SERVICE ALERT AT (800) 227-2600 AT LEAST 48 HOURS PRIOR TO ANY CONSTRUCTION. SEE SPECIAL PROVISIONS FOR CONTRACTOR NOTIFICATION REQUIREMENTS. THE CONTRACTOR SHALL ASSUME COMPLETE RESPONSIBILITY FOR DAMAGED UTILITIES.

4. UNLESS NOTED OTHERWISE ON THE PLANS, THE CONTRACTOR SHALL BE RESPONSIBLE FOR THE PROTECTION OF ALL EXISTING SURVEY MONUMENTS AND OTHER SURVEY MARKERS DURING CONSTRUCTION.

5. THE CONTRACTOR SHALL PROVIDE, PLACE, AND MAINTAIN ALL LIGHTS, SIGNS, BARRICADES, FLAG PERSONS, PILOT CAR, OR OTHER DEVICES NECESSARY TO CONTROL TRAFFIC THROUGH THE CONSTRUCTION AREA AND FOR PUBLIC SAFETY IN ACCORDANCE WITH THESE PLANS, THE STANDARD SPECIFICATIONS, FEDERAL HIGHWAY ADMINISTRATION (FHWA) MANUAL ON UNIFORM TRAFFIC CONTROL DEVICES (MUTCD) 2009 EDITION AND MUTCD 2012 CALIFORNIA SUPPLEMENT.

6. THE CONTRACTOR AGREES TO ASSUME SOLE AND COMPLETE RESPONSIBILITY FOR JOB SITE CONDITIONS DURING THE COURSE OF CONSTRUCTION OF THIS PROJECT, INCLUDING SAFETY OF ALL PERSONS AND PROPERTY, AND FURTHER AGREES THAT THIS REQUIREMENT SHALL APPLY CONTINUOUSLY AND NOT BE LIMITED TO NORMAL WORKING HOURS IN ACCORDANCE WITH THE PROVISIONS OUTLINED BY THE PROJECT CONTRACT AND STANDARD SPECIFICATIONS.

7. THERE SHALL BE NO GRADING OR LAND DISTURBANCE PERFORMED WITH RESPECT TO THE PROJECT BETWEEN OCTOBER 15 AND MAY 1 UNLESS A GRADING EXEMPTION IS OBTAINED FROM THE TAHOE REGIONAL PLANNING AGENCY (TRPA). APPROVALS FOR GRADING BETWEEN OCTOBER 15 AND MAY 1 MUST ALSO BE OBTAINED FROM THE REGIONAL WATER QUALITY CONTROL BOARD, LAHONTAN. IF REQUIRED, THE COUNTY SHALL OBTAIN THESE APPROVALS.

8. THE CONTRACTOR SHALL MAINTAIN A SET OF PLANS ON THE JOB SHOWING "AS-CONSTRUCTED" CHANGES MADE TO DATE. UPON COMPLETION OF THE PROJECT, THE CONTRACTOR SHALL SUPPLY TO THE AGENCIES A SET OF PLANS, MARKED UP TO THE SATISFACTION OF THE AGENCIES, REFLECTING THE AS-CONSTRUCTED MODIFICATIONS.

9. ALL CONTROL STATIONING AND DATA DIMENSIONING ARE REFERENCED TO THE CENTERLINE OF THE FACILITY SHOWN UNLESS OTHERWISE NOTED.

10. AT NO TIME SHALL THE CONTRACTOR UNDERTAKE TO CLOSE OFF ANY EXISTING UTILITY LINES OR OPEN VALVES OR TAKE ANY OTHER ACTION WHICH WOULD AFFECT THE OPERATION OF EXISTING WATER OR SEWER SYSTEMS WITHOUT PRIOR APPROVAL FROM THE SOUTH TAHOE PUBLIC UTILITY DISTRICT (STPUD). APPROVAL SHALL BE REQUESTED AT LEAST 48 HOURS IN ADVANCE OF THE TIME THAT THE INTERRUPTION OF THE EXISTING SYSTEM IS REQUIRED. ANY INTERRUPTION OF SERVICE TO ACTIVE WATER OR SEWER SERVICES, INCLUDING FIRE HYDRANTS, WHETHER INTENTIONAL OR NOT, MUST BE KEPT TO A MINIMUM TIME PERIOD. IF SERVICE TO BUILDINGS IS TO BE OFF FOR MORE THAN FOUR HOURS, THE CONTRACTOR MUST ADVISE STPUD.

11. THE CONTRACTOR SHALL BE REQUIRED TO PERFORM PREVENTIVE DUST CONTROL MEASURES TO ENSURE THAT DUST RESULTING FROM THE CONTRACTOR'S PERFORMANCE OF THE WORK IS CONTROLLED IN CONFORMANCE WITH THE SPECIAL PROVISIONS, THE PROVISIONS THE STANDARD SPECIFICATIONS, COUNTY, AND LOCAL ORDINANCES. SEE SPECIAL PROVISIONS REGARDING SWEEPING, DUST CONTROL AND TRACKING REQUIREMENTS.

12. THE CONTRACTOR SHALL BE RESPONSIBLE FOR IMPLEMENTING ALL TEMPORARY EROSION CONTROL MEASURES. THE EROSION CONTROL MEASURES SHALL BE IN ACCORDANCE WITH THE TRPA "HANDBOOK OF BEST MANAGEMENT PRACTICES" AND THE STORM WATER POLLUTION PREVENTION PLAN (SWPPP). THE DOT SHALL CONTACT TRPA PRIOR TO THE COMMENCEMENT OF WORK FOR A PRE-GRADING INSPECTION OF THE INSTALLED TEMPORARY EROSION CONTROL FACILITIES. THE CONTRACTOR SHALL BE RESPONSIBLE FOR THE MAINTENANCE AND PERFORMANCE OF THE TEMPORARY EROSION CONTROL MEASURES THROUGHOUT THE DURATION OF THE PROJECT. SEE SPECIAL PROVISIONS REGARDING TEMPORARY EROSION CONTROL FACILITY REMOVAL.

13. CONSTRUCTION LIMITS SHOWN ON THE PLANS DELINEATE BOUNDARIES FOR THE CONTRACTOR'S OPERATIONS OUTSIDE THE COUNTY STREET RIGHT-OF-WAY. CONSTRUCTION LIMIT FENCING SHALL BE ERECTED ALONG THESE BOUNDARIES PRIOR TO COMMENCEMENT OF CONSTRUCTION. WITHIN THE CONSTRUCTION LIMITS, EXISTING VEGETATION SHALL BE PROTECTED TO THE EXTENT FEASIBLE. ALL EXISTING TREES SHALL BE PROTECTED UNLESS SHOWN ON THE PLANS TO BE REMOVED. SEE SPECIAL PROVISIONS REGARDING PAYMENT FOR TREE REMOVAL.

14. ALL REVEGETATION SHOWN ON THE PLANS IS TO BE COMPLETED BY OTHERS, UNLESS NOTED OTHERWISE.

15. THE CONTRACTOR SHALL USE ONLY DESIGNATED SPECIFIC SITES FOR STORAGE OF EQUIPMENT AND MATERIALS AS SHOWN ON THESE PLANS. THE CONTRACTOR SHALL BE RESPONSIBLE FOR THE SECURITY OF ALL EQUIPMENT AND MATERIALS.

16. IT IS THE RESPONSIBILITY OF THE CONTRACTOR AND HIS SUBCONTRACTOR(S) TO EXAMINE THE PROJECT SITE PRIOR TO THE OPENING OF BID PROPOSALS. THE CONTRACTOR SHALL BECOME FAMILIAR WITH THE CONDITIONS UNDER WHICH THE WORK IS TO BE PERFORMED, SUCH AS THE NATURE AND LOCATION OF THE WORK AND THE GENERAL AND LOCAL CONDITIONS, PARTICULARLY THOSE AFFECTING THE AVAILABILITY OF TRANSPORTATION, THE DISPOSAL, HANDLING, AND STORAGE OF MATERIALS, AVAILABILITY OF LABOR, WATER, ELECTRICITY, ROADS, THE UNCERTAINTIES OF WEATHER, THE CONDITIONS OF THE GROUND, SURFACE AND SUBSURFACE MATERIALS, THE EQUIPMENT AND FACILITIES NEEDED PRIMARILY FOR AND DURING THE PERFORMANCE OF THE WORK, AND THE COSTS THEREOF. ANY FAILURE BY THE CONTRACTOR AND SUBCONTRACTOR(S) TO ACQUAINT HIMSELF WITH ALL THE AVAILABLE INFORMATION WILL NOT RELIEVE HIM FROM RESPONSIBILITY FOR PROPERLY ESTIMATING THE DIFFICULTY AND COST OF SUCCESSFULLY PERFORMING THE WORK.

17. ELEVATIONS SHOWN ON THE PLANS FOR PIPE INVERTS, TOPS OF GRATES, RIMS, CURBS, ETC., ARE BASED UPON THE TOPOGRAPHIC INFORMATION SHOWN ON THE PLANS. THE CONTRACTOR SHALL VERIFY ALL NECESSARY SURFACE ELEVATIONS IN THE FIELD AND NOTIFY THE DGS OF ANY DISCREPANCIES, WHICH MIGHT AFFECT PROPER OPERATION OF THE NEW FACILITIES BEFORE BREAKING GROUND AND PRIOR TO FACILITY INSTALLATION. THE DOT SHALL BE CONTACTED IN THE EVENT ELEVATIONS ARE INCORRECT SO THAT THE PROPER ADJUSTMENTS CAN BE MADE PRIOR TO THE INSTALLATION OF THE FACILITIES, AS SET FORTH IN THE SPECIAL PROVISIONS.

18. THE CONTRACTOR SHALL OBTAIN AT HIS OWN EXPENSE ALL PERMITS, LICENSES, INSURANCE POLICIES, ETC., NOT ALREADY OBTAINED BY DGS, AS MAY BE NECESSARY TO COMPLY WITH STATE AND LOCAL LAWS ASSOCIATED WITH THE PERFORMANCE OF THE WORK. SEE SPECIAL PROVISIONS.

19. THE CONTRACTOR IS RESPONSIBLE TO REVIEW THE CONTRACT DOCUMENTS FOR ALL SUBMITTALS REQUIRED FOR DGS REVIEW AND ACCEPTANCE.

20. THE DGS WILL FURNISH THE CONSTRUCTION STAKING TO THE CONTRACTOR AS SET FORTH IN THE SPECIAL PROVISIONS.

21. CONTRACTOR SHALL NOTE THAT THE PLANS SHOW BOTH HORIZONTAL AND SLOPE (ACTUAL) LENGTHS FOR PIPE. SEE SPECIAL PROVISIONS FOR THE MAXIMUM ALLOWABLE DEFLECTION ANGLE AT EACH PIPE JOINT.

22. THE CONSULTANT TEAM AND OVERSEEING ENGINEER RESPONSIBLE FOR PREPARATION OF THESE PLANS AND SPECIFICATIONS WILL NOT BE RESPONSIBLE FOR, OR LIABLE FOR UNAUTHORIZED CHANGES TO OR USES OF THESE PLANS. ALL CHANGES TO THE PLANS MUST BE IN WRITING AND MUST BE APPROVED BY THE CONSULTANT TEAM AND OVERSEEING ENGINEER RESPONSIBLE FOR PREPARATION OF THESE PLANS.

23. NO TREES OR WETLAND VEGETATION SHALL BE REMOVED UNLESS THEY ARE SHOWN AND NOTED TO BE REMOVED ON THE PLANS, OR AS DIRECTLY SPECIFIED ON-SITE BY THE PROJECT MANAGEMENT STAFF. ALL TREES CONFLICTING WITH GRADING SHALL BE TRIMMED. NO GRADING SHALL TAKE PLACE WITHIN THE DRIP LINE OF TREES NOT TO BE REMOVED UNLESS OTHERWISE APPROVED.

24. IF, DURING CONSTRUCTION, ARCHAEOLOGICAL REMAINS ARE ENCOUNTERED, CONSTRUCTION IN THE VICINITY SHALL BE HALTED, AND THE STATE OFFICE OF HISTORIC PRESERVATION AND A QUALIFIED ARCHEOLOGIST SHALL BE NOTIFIED IMMEDIATELY.

25. PERMIT CONDITIONS MAY CONTAIN SPECIFIC REQUIREMENTS FOR THE CONTROL OF OFF-SITE TURBIDITY FROM PROJECT OPERATIONS. TURBIDITY WILL BE MONITORED ON A FREQUENT BASIS BY THE PROJECT MANAGEMENT AND INSPECTION STAFF ON-SITE. TURBIDITY AMOUNTS IN EXCESS OF THE PERMITTED AMOUNT AND/OR DURATIONS WILL CAUSE WORK TO BE STOPPED UNTIL IMPROVED PRACTICES ARE IN EFFECT AND THE PROBLEMS CONTROLLED. THE CONTRACTOR IS COMPLETELY RESPONSIBLE FOR ANY PROJECT DELAYS THAT OCCUR BY NATURE OF THIS FAILURE TO ADEQUATELY CONTAIN SEDIMENT ON-SITE

26. THE NEW CHANNEL ALIGNMENTS OF EACH ALTERNATIVE DEPICTED ON THE PLANS ARE APPROXIMATE AND ARE NOT INTENDED TO REPRESENT THE FINAL ALIGNEMENT.
- | ABBREVIATIONS | | | |
|---------------|--------------------------------|---------|-------------------------------------|
| A | ASPEN | FL | FLOWLINE |
| ABAND | ABANDONED | FS | FINISH SURFACE |
| AC | ASPHALT CONCRETE | G | GAS |
| APN | ASSESSOR'S PARCEL NUMBER | IE | INVERT ELEVATION |
| BLVD | BOULEVARD | INST | INSTALL |
| CA | CALIFORNIA | IB | ISOLATION BARRIER |
| CALC'S | CALCULATIONS | LF | LINEAR FEET |
| CF | CUBIC FEET OR CURB FACE | LT | LEFT |
| CIR | CIRCLE | LT BLVD | LAKE TAHOE BLVD |
| CL | CENTERLINE | MISC | MISCELLANEOUS |
| CLF | CONSTRUCTION LIMIT FENCE | N | NORTH |
| CLR | CLEAR | NTS | NOT TO SCALE |
| CO. | COUNTY | OH | OVERHEAD |
| CONC | CONCRETE | P | PINE |
| CONST | CONSTRUCT | PL | PROPERTY LINE |
| CMP | CORRUGATED METAL PIPE | PP | POWER/UTILITY POLE |
| CT | CALTRANS OR COURT | PROP | PROPOSED |
| CTC | CALIFORNIA TAHOE CONSERVANCY | PUE | PUBLIC UTILITY EASEMENT |
| CY | CUBIC YARD | RD | ROAD |
| DET | DETAIL | REF | REFERENCE |
| DGS | DEPARTMENT OF GENERAL SERVICES | ROW | RIGHT-OF-WAY |
| DI | DRAINAGE INLET | RSP | ROCK SLOPE PROTECTION |
| DIA OR Ø | DIAMETER | RT | RIGHT |
| DISS | DISSIPATER | S | SOUTH OR SANITARY SEWER |
| DR | DRIVE | SD | STORM DRAIN |
| D/W | DRIVEWAY | SDMH | STORM DRAIN MANHOLE |
| E | EAST | SF | SQUARE FEET |
| EA | EACH | SHT | SHEET |
| EG | EXISTING GRADE | SS | SANITARY SEWER |
| ELEV | ELEVATION | ST | SEDIMENT TRAP OR STREET |
| ELEC | ELECTRIC | STA | STATION |
| EP | EDGE OF PAVEMENT | STPUD | SOUTH TAHOE PUBLIC UTILITY DISTRICT |
| EX | EXISTING | TRPA | TAHOE REGIONAL PLANNING AGENCY |
| F | FIR | TYP | TYPICAL |
| FES | FLARED END SECTION | USFS | UNITED STATES FOREST SERVICE |
| FF | FILTER FENCE | W | WEST OR WATER |
| FG | FINISHED GRADE | W/ | WITH |
| FH | FIRE HYDRANT | W/O | WITHOUT |
- | UTILITIES | |
|------------------|--|
| CABLE TELEVISION | CHARTER COMMUNICATIONS, (775) 850-1290 |
| NATURAL GAS | SOUTHWEST GAS CO., (775) 887-2872 |
| ELECTRIC | LIBERTY ENERGY, (530) 541-2040 |
| SEWER & WATER | SOUTH TAHOE PUD, (530) 543-5247 |
| TELEPHONE | AT&T, (916) 453-6136 |
| STORM DRAIN | CITY OF SOUTH LAKE TAHOE, DPW (530) 542-6030 |
- HORIZONTAL AND VERTICAL CONTROL/PROJECTION

VERTICAL CONTROL IS NGVD 29; HORIZONTAL CONTROL IS CALIFORNIA STATE PLANE, ZONE 2, NAD 83 (FEET);
- | LEGEND | | | |
|--|--|----------|-------------------------------------|
| *NOTE: LEGEND PROVIDED ON SHEET SUPERCEDES THIS LEGEND | | | |
| EXISTING | | PROPOSED | |
| | MAJOR CONTOUR | | FOOT TRAIL |
| | MINOR CONTOUR | | PIPE (MATERIAL AS NOTED) |
| | WATERS EDGE | | FILL |
| | STRUCTURE BOUNDARY | | CUT |
| | PROPERTY LINE | | BOULDER TOE PROTECTION |
| | FENCELINE | | NEW FLOODPLAIN |
| | FOOT TRAIL | | SCOUR POOL |
| | WATER LINE | | POINT BAR |
| | SEWER LINE | | ROCK DISSIPATER |
| | GAS LINE | | RESTORED DUNES |
| | STORM DRAIN | | STORMWATER TREATMENT AREA |
| | ELECTRIC LINE | | MAJOR CONTOUR |
| | AC PAVEMENT | | MINOR CONTOUR |
| | WOODEN FOOT BRIDGE | | TAHOE YELLOW CRESS PROTECTED AREA |
| | UTILITY EASEMENT | | BOARDWALK |
| | POWER/UTILITY POLE | | BRIDGE |
| | UTILITY POLE & GUY ANCHOR | | GRADE CONTROL STRUCTURE |
| | FIRE HYDRANT | | NEW CHANNEL ALIGNMENT |
| | DRAINAGE INLET | | RE-VEGETATION |
| | LIGHT POLE | | EXISTING RIVER ACCESS STABILIZATION |
| | MANHOLE | | FISHING ACCESS |
| | UTILITY BOX | | ADA ACCESSIBLE |
| | SIGN | | OBSERVATION AREA |
| | TREE, DIAMETER AND TYPE | | SELF-SERVICE VISITORS CENTER |
| | EXISTING CHANNEL ALIGNMENT STATION NUMBER AND MARKER | | PARKING |
| | | | VIEWPOINT |
| | | | DETAIL REF NUMBER SHEET NUMBER |
-
- UPPER TRUCKEE RIVER
AND MARSH RESTORATION
PROJECT
- E.I.P. # 560
-
- 870 Emerald Bay Road, Suite 400
South Lake Tahoe, CA 96150
Tel: 530.543.5100 Fax: 530.543.5150
-
- 295 Highway 50, suite 1
Zephyr Cove, NV 89448
Tel: 775.588.9069
- GENERAL NOTES,
ABBREVIATIONS,
& LEGEND
- ii
- REVISIONS
- | # | description | date |
|---|-------------|------|
| | | |
| | | |
| | | |
| | | |
| | | |
| | | |
| | | |
| | | |
| | | |
- scale: AS SHOWN
- job no.: 00110066.04
- drawn by: MC
- checked by: CM
- sheet no.: ii
- sheet 2 of 45
- date: 01/10/13
- SCHEMATIC DESIGN PLANS
& DETAILS
NOT FOR CONSTRUCTION

ALTERNATIVE ONE

YEAR 1

- MOBILIZATION, INCLUDING HAUL ROAD AND STAGING AREA CONSTRUCTION, BMP INSTALLATION, SIGNAGE PLACEMENT.
- CONSTRUCTION OF HIGH FLOW CHANNEL (STA 1700 - 2900)
- CLEARING AND GRUBBING ALONG THE EAST SIDE OF THE UPPER TRUCKEE RIVER AND INSTALL A THE ISOLATION BARRIER (IB).
- EXCAVATE THE EXISTING EASTERN HIGH FLOW CHANNEL.
- REVEGETATE AND IRRIGATE ALL DISTURBED AREAS
- CONSTRUCTION OF NEW CHANNEL AND REGRADING OF LOWER WEST SIDE AREA (STA 6300-9300)
- CLEARING AND GRUBBING OF THE LOWER WEST SIDE AREA TO ALLOW FOR RE-GRADING OF THE FLOODPLAIN AND INSTALL AN IB.
- RE-GRADE AND REVEGETATE THE LOWER WEST SIDE AREA.
- A BULKHEAD/LEEVEE SHALL BE CONSTRUCTED ACROSS THE SAILING LAGOON TO SEGREGATE IT FROM THE TAHOE KEYS MARINA.
- INSTALL AN IB ALONG THE EXISTING CHANNEL ALIGNMENT TO SEPARATE THE RIVER FROM ITS FLOODPLAIN, AND THE NEW CHANNEL SHALL BE CONSTRUCTED.
- UPON COMPLETION OF ALL CHANNEL AND FLOODPLAIN WORK, ALL DISTURBED AREAS SHALL BE REVEGETATED AND IRRIGATED.
- EAST MEADOW AND APPURTENANCES
- RE-ROUTE THE EXISTING TRAIL ACROSS THE NEW BULKHEAD/LEEVEE.
- AT THE END OF THE CONSTRUCTION SEASON, REMOVE IRRIGATION EQUIPMENT AND WINTERIZE THE SITE.

YEAR 2

BANK STABILIZATION (STA 0-1300)

- CLEARING AND GRUBBING FOR CONSTRUCTION OF THE ROCK TOE PROTECTION AND SCOUR POOL AND INSTALLATION OF THE ISOLATION BARRIER.
- EXCAVATE FLOODPLAIN AND CONSTRUCT POINT BAR.
- REVEGETATE AND IRRIGATE NEW FLOODPLAIN AND DISTURBED AREAS.

SEASONING OF HIGH FLOW CHANNEL (STA 1700 - 2900)

- IRRIGATION LINES WILL BE PLACED AND REVEGETATION INSPECTIONS WILL BE COMPLETED ON A MONTHLY BASIS.

VERTICAL GRADE CONTROL STRUCTURES (STA 2900-6300)

- DEWATER THE CHANNEL IN SECTIONS AND CONSTRUCT VERTICAL GRADE CONTROLS.
- ALL DISTURBED AREAS WILL BE REVEGETATED AND IRRIGATED.

RIVER MOUTH RE-CONFIGURATION (STA 9300-10700)

- CLEAR AND GRUB FOR CONSTRUCTION OF A GRADE CONTROL STRUCTURE.
- RESTORE THE DUNES OF EAST COVE BEACH.
- ALL DISTURBED AREAS SHALL BE REVEGETATED AND IRRIGATED.

SEASONING OF NEW CHANNEL AND IRRIGATION OF LOWER WEST SIDE AREA (STA 6300-9300)

- IRRIGATION LINES WILL BE PLACED AND REVEGETATION INSPECTIONS WILL BE COMPLETED ON A MONTHLY BASIS.

EAST MEADOW AND APPURTENANCES

- CONSTRUCT A CLASS I TRAIL SYSTEM THROUGH THE WOODED AREA NORTH OF HIGHLAND WOODS.
- CONSTRUCT A BOARDWALK AND OBSERVATION PLATFORMS ALONG THE EASTERN BOUNDARY.
- REMOVE FILL FROM BEHIND EAST BARTON BEACH.
- REVEGETATE AND IRRIGATE ALL DISTURBED AREAS.

YEAR 3

BANK STABILIZATION (STA 0-1300)

- IRRIGATION LINES WILL BE PLACED AND REVEGETATION INSPECTIONS WILL BE COMPLETED ON A MONTHLY BASIS.

DIVERSION TO HIGH FLOW CHANNEL (STA 1700 - 2900)

- REMOVE IB AND PUT THE RIVER IN THE NEW ALIGNMENT. FLUSH THE NEW CHANNEL TO INITIATE THE FLOWS.
- PLACE IB TO THE OLD SECTION OF CHANNEL. BACKFILL OLD CHANNEL AND REVEGETATE.
- INSTALL LATERAL GRADE CONTROL STRUCTURES AT THE UPSTREAM AND DOWNSTREAM ENDS OF THIS SECTION.
- REMOVE IB AND REVEGETATE AND IRRIGATE ALL DISTURBED.

VERTICAL GRADE CONTROL STRUCTURES (STA 2900-6300)

- IRRIGATION LINES WILL BE PLACED AND REVEGETATION INSPECTIONS WILL BE COMPLETED ON A MONTHLY BASIS.
- RESTORE THE SETTLING BASIN AND TKPOA CORPORATION YARD. ALL DISTURBED AREAS WILL BE REVEGETATED AND IRRIGATED.

DIVERSION TO NEW CHANNEL AND ABANDONMENT OF EXISTING CHANNEL (STA 6300-9300)

- PUT THE RIVER IN THE NEW ALIGNMENT AND MOVE IB TO ISOLATE THE OLD CHANNEL. DIVERT WATER FROM THE RIVER TO THE SAILING LAGOON TO ALLOW SETTLEMENT.
- THE NEW CHANNEL SECTION SHALL BE FLUSHED TO INITIATE THE FLOWS, AND THE OLD CHANNEL WILL BE BACKFILLED, REVEGETATED, AND IRRIGATED.
- CONVERGENCE OF NEW ALIGNMENT AND OLD ALIGNMENT WILL BE ARMORED WITH A COMBINATION OF VINYL SHEET PILE, ROCK AND LARGE WOOD ELEMENTS. WILLOW STAKES WILL BE INCORPORATED INTO THESE ENGINEERED AREAS AND PROPAGATED SOD WILL BE PLACED ON TOP OF THE ARMORED PROTECTION.

SEASONING OF RIVER MOUTH RE-CONFIGURATION (STA 9300-10700)

- THE NEW CHANNEL AND FLOODPLAIN WILL BE ALLOWED TO ESTABLISH VEGETATION AND SEASONED. IRRIGATION LINES WILL BE PLACED AS SOON AS POSSIBLE AND REVEGETATION INSPECTIONS WILL BE ON A MONTHLY BASIS.

EAST MEADOW AND APPURTENANCES

- IRRIGATION LINES WILL BE PLACED AND REVEGETATION INSPECTIONS WILL BE COMPLETED ON A MONTHLY BASIS.

YEAR 4

IRRIGATION AND VEGETATION MONITORING OF HIGH FLOW CHANNEL (STA 1700 - 2900) & VERTICAL GRADE CONTROL STRUCTURES (STA 2900-6300)& NEW CHANNEL AND LOWER WEST SIDE AREA (STA 6300-9300)

- IRRIGATION LINES WILL BE PLACED AND REVEGETATION INSPECTIONS WILL BE COMPLETED ON A MONTHLY BASIS.

DIVERSION TO RIVER MOUTH RE-CONFIGURATION (STA 9300 -10700)

- PLACE THE RIVER IN THE NEW ALIGNMENT AND RE-INSTALLING IB TO ISOLATE THE OLD SECTION OF CHANNEL.
- THE NEW CHANNEL WILL BE FLUSHED SEVERAL TIMES, AND THE OLD CHANNEL WILL BE BACKFILLED, REVEGETATED, AND IRRIGATED.

EAST MEADOW AND APPURTENANCES

- INSTALL INTERPRETIVE SIGNAGE THROUGHOUT THE SITE.
- CONSTRUCT CLASS I BIKE TRAIL ALONG VENICE DRIVE.
- CONSTRUCT A VISITOR'S CENTER AND PARKING LOT AT THE END OF VENICE DRIVE.
- REVEGETATE AND IRRIGATE ALL DISTURBED AREAS.

ALTERNATIVE TWO

YEAR 1

- MOBILIZATION, INCLUDING HAUL ROAD AND STAGING AREA CONSTRUCTION, BMP INSTALLATION, AND SIGNAGE PLACEMENT.
- CONSTRUCTION OF NEW GEOMORPHIC CHANNEL AND REGRADING OF LOWER WEST SIDE AREA (STA 2000 - 9300)
- CLEARING AND GRUBBING ALONG THE UPPER TRUCKEE RIVER AND INSTALLATION OF THE IB.
- RE-GRADING OF THE LOWER WEST SIDE AREA.
- CONSTRUCT THE BULKHEAD/LEEVEE ACROSS THE SAILING LAGOON.
- INSTALL AN IB ALONG THE EXISTING CHANNEL ON THE SIDE ADJACENT TO THE NEW CHANNEL, AND CONSTRUCT THE NEW CHANNEL.
- UPON COMPLETION OF ALL CHANNEL AND FLOODPLAIN WORK, ALL DISTURBED AREAS SHALL BE REVEGETATED AND IRRIGATED.
- EAST MEADOW AND APPURTENANCES
- RE-ROUTE THE EXISTING TRAIL ACROSS THE NEW BULKHEAD/LEEVEE.

YEAR 2

BANK STABILIZATION (STA 0-2000)

- CLEARING AND GRUBBING FOR CONSTRUCTION OF THE ROCK TOE PROTECTION AND SCOUR POOL AND INSTALL THE IB.
- CONSTRUCT ROCK TOE PROTECTION.
- EXCAVATE SECONDARY CHANNEL MOUTH AND CONSTRUCT POINT BAR.
- EXCAVATE FLOODPLAIN LOCATIONS
- REVEGETATE AND IRRIGATE NEW FLOODPLAIN AND DISTURBED AREAS AT THE CONCLUSION OF CONSTRUCTION.

SEASONING OF NEW GEOMORPHIC CHANNEL AND VEGETATION ESTABLISHMENT OF LOWER WEST SIDE AREA (STA 1300 - 9300)

- IRRIGATION LINES WILL BE PLACED AND REVEGETATION INSPECTIONS WILL BE COMPLETED ON A MONTHLY BASIS.

RIVER MOUTH RE-CONFIGURATION (STA 9300-10700)

- CLEARING AND GRUBBING ALONG THE UPPER TRUCKEE RIVER AND INSTALLATION OF THE IB.
- CONSTRUCT NEW CHANNEL WITH VERTICAL GRADE CONTROLS
- THE DUNES AREA SHALL BE RESTORED ACCORDING TO THE PLANS AND SPECIFICATIONS.
- ALL DISTURBED AREAS SHALL BE REVEGETATED AND IRRIGATED.

EAST MEADOW AND APPURTENANCES

- CONSTRUCT OBSERVATION PLATFORMS ALONG THE EASTERN BOUNDARY.
- REMOVE FILL FROM BEHIND EAST BARTON BEACH
- REVEGETATE AND IRRIGATE ALL DISTURBED AREAS.

YEAR 3

BANK STABILIZATION (STA 0-2000)

- IRRIGATION LINES WILL BE PLACED AND REVEGETATION INSPECTIONS WILL BE COMPLETED ON A MONTHLY BASIS.

DIVERSION TO NEW GEOMORPHIC CHANNEL; ABANDONMENT OF EXISTING CHANNEL; VEGETATION ESTABLISHMENT OF LOWER WEST SIDE AREA (STA 2000 - 9300)

- REMOVE IB AND PUT RIVER IN THE NEW ALIGNMENT. INSTALL IB TO ISOLATE FOR BACKFILL OF OLD RIVER ALIGNMENT.
- THE OLD CHANNEL WILL BE BACKFILLED, REVEGETATED, AND IRRIGATED.
- WHERE THE NEW ALIGNMENT AND EXISTING ALIGNMENT CONVERGE WILL BE ARMORED WITH A COMBINATION OF VINYL SHEET PILE, ROCK AND LARGE WOOD ELEMENTS. WILLOW STAKES WILL BE INCORPORATED INTO THESE ENGINEERED AREAS AND PROPAGATED SOD WILL BE PLACED ON TOP OF THE ARMORED PROTECTION.
- CONSTRUCT A VERTICAL GRADE CONTROL STRUCTURE ON THE UPSTREAM END OF THIS SECTION.
- STORMWATER TREATMENT AREAS SHALL BE CONSTRUCTED IN THE FLOODPLAIN NEAR THE TKPOA YARD.
- RESTORE THE SETTLING BASIN AND TKPOA CORPORATION YARD.
- ALL DISTURBED AREAS SHALL BE REVEGETATED AND IRRIGATED.

SEASONING OF RIVER MOUTH RE-CONFIGURATION (STA 9300-10700)& EAST MEADOW AND APPURTENANCES

- IRRIGATION LINES WILL BE PLACED AND REVEGETATION INSPECTIONS WILL BE COMPLETED ON A MONTHLY BASIS.

YEAR 4

IRRIGATION AND VEGETATION MONITORING OF NEW GEOMORPHIC CHANNEL; EXISTING CHANNEL; LOWER WEST SIDE AREA (STA 2000 - 9300)

- AS EARLY AS POSSIBLE, AN INSPECTION WILL BE COMPLETED TO EVALUATE THE CONDITION OF IMPROVEMENTS.
- IRRIGATION LINES WILL BE PLACED AS SOON AS POSSIBLE AND REVEGETATION INSPECTIONS WILL BE COMPLETED ON A MONTHLY BASIS.
- CONSTRUCT FISHING PLATFORM

DIVERSION INTO RIVER MOUTH RE-CONFIGURATION (STA 9300-10700)

- THIS YEAR THE RIVER SHALL BE PUT IN THE NEW ALIGNMENT BY REMOVING THE IB AND RE-INSTALLING IT TO ISOLATE THE OLD SECTION OF CHANNEL.
- THE NEW CHANNEL SECTION SHALL BE FLUSHED SEVERAL TIMES TO INITIATE THE FLOWS, AND THE OLD CHANNEL WILL BE BACKFILLED, REVEGETATED, AND IRRIGATED.

EAST MEADOW AND APPURTENANCES

- INSTALL INTERPRETIVE SIGNAGE THROUGHOUT THE SITE.
- REVEGETATE AND IRRIGATE ALL DISTURBED AREAS.

ALTERNATIVE THREE

YEAR 1

- MOBILIZATION, INCLUDING HAUL ROAD AND STAGING AREA CONSTRUCTION, BMP INSTALLATION, SIGNAGE PLACEMENT.
- CONSTRUCTION OF NEW GEOMORPHIC PILOT CHANNEL AND REGRADING OF LOWER WEST SIDE AREA (STA 3000-9300)
- CLEARING AND GRUBBING ALONG THE UPPER TRUCKEE RIVER TO INSTALL AN IB. EXCAVATE A PILOT CHANNEL.
- REGRADE THE LOWER WEST SIDE AREA.
- A BULKHEAD SHALL BE CONSTRUCTED ACROSS THE SAILING LAGOON TO SEGREGATE IT FROM THE TAHOE KEYS MARINA.
- INSTALL IB TO ISOLATE THE UPPER TRUCKEE RIVER FROM ITS FLOODPLAIN IN THE VICINITY OF THE NEW PILOT CHANNEL.
- EXCAVATE THE NEW PILOT CHANNEL (~1800').
- THE CONTRACTOR SHALL INSTALL A VERTICAL GRADE CONTROL
- THE NEW FLOODPLAIN, CHANNEL AND ANY DISTURBED AREAS WILL BE REVEGETATED AND IRRIGATED.
- EAST MEADOW AND APPURTENANCES
- RE-ROUTE THE EXISTING TRAIL ACROSS THE NEW BULKHEAD LEEVEE.

YEAR 2

CONSTRUCTION OF BANK STABILIZATION AND OVERBANK CONVEYANCE (STA 0-1300)

- CLEARING AND GRUBBING FOR CONSTRUCTION OF THE ROCK TOE PROTECTION AND SCOUR POOL AND INSTALLATION OF THE ISOLATION BARRIER.
- EXCAVATE FLOODPLAIN AND CONSTRUCT POINT BAR.
- CONSTRUCT TWO 48" CMP ARCH PIPES BENEATH HWY 50 TO THE WEST OF THE BRIDGE STRUCTURE.
- CONSTRUCT A ROCK HEADWALL UPSTREAM, AND A ROCK DISSIPATER SHALL BE INSTALLED AT THE DOWNSTREAM END.
- REVEGETATE AND IRRIGATE NEW FLOODPLAIN AND DISTURBED AREAS.

CONSTRUCTION OF LOWERED FLOODPLAIN (STA 1700 - 3000)

- CLEARING AND GRUBBING ALONG THE UPPER TRUCKEE RIVER TO ALLOW FOR CONSTRUCTION OF NEW FLOODPLAIN.
- EXCAVATE THE EXISTING FLOODPLAIN. REVEGETATION AND IRRIGATION OF NEW FLOODPLAIN AND DISTURBED AREAS SHALL COMMENCE AT THE CONCLUSION OF CONSTRUCTION.

SEASONING OF NEW GEOMORPHIC PILOT CHANNEL AND LOWER WEST SIDE AREA (STA 3000-9300)

- IRRIGATION LINES WILL BE PLACED AND REVEGETATION INSPECTIONS WILL BE COMPLETED ON A MONTHLY BASIS.

CONSTRUCTION OF RIVER MOUTH RE-CONFIGURATION (STA 9300-10700)

- CLEARING AND GRUBBING WILL BE COMPLETED TO ALLOW FOR INSTALLATION OF THE GRADE CONTROL STRUCTURE.
- INSTALL AN IB AND CONSTRUCT THE GRADE CONTROL STRUCTURE
- RESTORE THE DUNES AT EAST COVE BEACH.
- ALL DISTURBED AREAS SHALL BE REVEGETATED AND IRRIGATED.

EAST MEADOW AND APPURTENANCES

- CONSTRUCT TRAILS AND BOARDWALKS, AND OBSERVATION PLATFORMS ALONG THE EASTERN BOUNDARY.
- CONSTRUCT LOOP TRAIL THROUGH WOODS NORTH OF HIGHLAND WOODS.
- REVEGETATE AND IRRIGATE ALL DISTURBED AREAS.

YEAR 3

IRRIGATION AND VEGETATION ESTABLISHMENT OF BANK STABILIZATION & OVERBANK CONVEYANCE (STA 0-1300)

- AS EARLY AS POSSIBLE, AN INSPECTION WILL BE COMPLETED TO EVALUATE THE CONDITION OF IMPROVEMENTS.
- IRRIGATION LINES WILL BE PLACED AS SOON AS POSSIBLE AND REVEGETATION INSPECTIONS WILL BE COMPLETED ON A MONTHLY BASIS.

IRRIGATION AND VEGETATION ESTABLISHMENT OF LOWERED FLOODPLAIN (STA 1300 - 3000)

- AS EARLY AS POSSIBLE, AN INSPECTION WILL BE COMPLETED TO EVALUATE THE CONDITION OF IMPROVEMENTS.
- IRRIGATION LINES WILL BE PLACED AS SOON AS POSSIBLE AND REVEGETATION INSPECTIONS WILL BE COMPLETED ON A MONTHLY BASIS.

DIVERSION TO NEW GEOMORPHIC PILOT CHANNEL AND ABANDONMENT OF EXISTING CHANNEL (STA 3000-9300)

- THIS YEAR, THE RIVER WILL BE PUT IN THE NEW ALIGNMENT BY REMOVING THE ISOLATION BARRIER AND RE-INSTALLING IT TO ISOLATE THE OLD SECTION OF CHANNEL. THE RIVER FLOW WILL BE DIVERTED TO THE PILOT CHANNEL AND ALLOWED TO FIND ITS OWN PATH BACK TO LAKE TAHOE.
- AFTER THE WATER IS DIVERTED TO THE NEW CHANNEL, THE OLD CHANNEL WILL BE BACKFILLED, REVEGETATED, AND IRRIGATED.
- CONVERGENCE OF THE NEW ALIGNMENT AND OLD ALIGNMENT CONVERGE WILL BE ARMORED WITH A COMBINATION OF ROCK AND LARGE WOOD ELEMENTS. WILLOW STAKES WILL BE INCORPORATED INTO THESE ENGINEERED AREAS AND PROPAGATED SOD WILL BE PLACED AS NEEDED ON TOP OF THE ARMORED PROTECTION.

SEASONING OF RIVER MOUTH RE-CONFIGURATION (STA 9300-10700) & EAST MEADOW AND APPURTENANCES

- IRRIGATION LINES WILL BE PLACED AND REVEGETATION INSPECTIONS WILL BE COMPLETED ON A MONTHLY BASIS.

YEAR 4

IRRIGATION AND VEGETATION ESTABLISHMENT OF NEW GEOMORPHIC PILOT CHANNEL, EXISTING CHANNEL, AND LOWER WEST SIDE AREA (STA 3000-9300)

- IRRIGATION LINES WILL BE PLACED AND REVEGETATION INSPECTIONS WILL BE COMPLETED ON A MONTHLY BASIS.
- STORMWATER TREATMENT AREAS SHALL BE CONSTRUCTED IN THE FLOODPLAIN NEAR THE TKPOA YARD AND THE TKPOA YARD SHALL BE RESTORED ACCORDING TO THE PLANS AND SPECIFICATIONS. ALL DISTURBED AREAS SHALL BE REVEGETATED AND IRRIGATED.

DIVERSION TO RIVER MOUTH RE-CONFIGURATION (STA 9300 -10700)

- THIS YEAR THE RIVER WILL BE PUT IN THE NEW ALIGNMENT BY REMOVING THE ISOLATION BARRIER AND RE-INSTALLING IT TO ISOLATE THE OLD SECTION OF CHANNEL.
- THE NEW CHANNEL WILL BE FLUSHED SEVERAL TIMES TO INITIATE THE FLOWS, AND THE OLD CHANNEL WILL BE BACKFILLED, REVEGETATED, AND IRRIGATED.

EAST MEADOW AND APPURTENANCES

- INSTALL INTERPRETIVE SIGNAGE THROUGHOUT THE SITE.
- CONSTRUCT SELF-SERVE KIOSK AT THE END OF VENICE DRIVE

ALTERNATIVE FOUR

YEAR 1

- MOBILIZATION, INCLUDING HAUL ROAD AND STAGING AREA CONSTRUCTION, BMP INSTALLATION, AND SIGNAGE PLACEMENT.
- CONSTRUCTION OF NEW CHANNEL AND REGRADING OF LOWER WEST SIDE AREA (STA 6700-9300)
- CLEARING AND GRUBBING ALONG THE UPPER TRUCKEE RIVER TO ALLOW FOR INSTALLATION OF THE IB, EXCAVATE THE NEW CHANNEL AND REGRADE THE LOWER WEST SIDE AREA.
- INSTALL THE IB TO ISOLATE THE UPPER TRUCKEE RIVER FROM ITS FLOODPLAIN IN THE VICINITY OF LOWER WEST SIDE.
- THE NEW FLOODPLAIN, CHANNEL AND ANY DISTURBED AREAS WILL BE REVEGETATED AND IRRIGATED.
- CONSTRUCTION OF RIVER MOUTH RE-CONFIGURATION (STA 9300-10700)
- CLEARING AND GRUBBING WILL BE COMPLETED TO ALLOW FOR RE-CONFIGURATION OF THE CHANNEL MOUTH.
- INSTALL AN IB AND DEWATER THE CHANNEL.
- REGRADE THE MOUTH AREA THE AND USE LOCAL CUT AND FILL TO REGRADE THE MOUTH AREA TO THE LINES AND GRADES DEPICTED IN THE DRAWINGS.
- WHEN CONSTRUCTION IS COMPLETE, THE WATER WILL BE RETURNED TO THE CHANNEL AND THE TEMPORARY DIVERSION WILL BE REMOVED.
- ALL DISTURBED AREAS SHALL BE REVEGETATED AND IRRIGATED FOR ONE YEAR.

YEAR 2

CONSTRUCTION OF BANK STABILIZATION & INSET FLOODPLAIN (STA 0-1300)

- CLEARING AND GRUBBING FOR CONSTRUCTION OF THE ROCK TOE PROTECTION AND SCOUR POOL AND INSTALLATION OF THE ISOLATION BARRIER. CONSTRUCT ROCK TOE PROTECTION.
- EXCAVATE FLOODPLAIN AND CONSTRUCT POINT BAR.
- REVEGETATE AND IRRIGATE NEW FLOODPLAIN AND DISTURBED AREAS.

CONSTRUCTION OF INSET FLOODPLAIN (STA 1300 - 6700)

- CLEARING AND GRUBBING ALONG THE UPPER TRUCKEE RIVER TO ALLOW FOR CONSTRUCTION OF NEW FLOODPLAIN.
- EXCAVATE THE EXISTING FLOODPLAIN.
- REVEGETATION AND IRRIGATION OF NEW FLOODPLAIN AND DISTURBED AREAS.

SEASONING OF NEW CHANNEL AND LOWER WEST SIDE AREA (STA 6700-9300) & SEASONING OF RIVER MOUTH RE-CONFIGURATION (STA 9300-10700)

- IRRIGATION LINES WILL BE PLACED AND REVEGETATION INSPECTIONS WILL BE COMPLETED ON A MONTHLY BASIS.

EAST MEADOW AND APPURTENANCES

- CONSTRUCT TRAILS AND BOARDWALKS, AND OBSERVATION PLATFORMS ALONG THE EASTERN BOUNDARY ACCORDING TO THE PLANS AND SPECIFICATIONS.
- CONSTRUCT A PERIMETER CLASS I BIKE TRAIL ALONG THE SOUTHERN BORDER OF THE SITE.
- REVEGETATE AND IRRIGATE ALL DISTURBED AREAS.

YEAR 3

SEASONING OF BANK STABILIZATION & INSET FLOODPLAIN (STA 0-1300) & SEASONING OF INSET FLOODPLAIN (STA 1300 - 6700)

- IRRIGATION LINES WILL BE PLACED AND REVEGETATION INSPECTIONS WILL BE COMPLETED ON A MONTHLY BASIS.

DIVERSION TO NEW CHANNEL AND ABANDONMENT OF EXISTING CHANNEL (STA 6700-9300)

- THIS YEAR, THE RIVER WILL BE PUT IN THE NEW ALIGNMENT BY REMOVING THE ISOLATION BARRIER AND RE-INSTALLING IT TO ISOLATE THE OLD SECTION OF CHANNEL.
- AS EACH SECTION OF NEW CHANNEL IS BROUGHT ON-LINE, THE NEW CHANNEL SECTION SHALL BE FLUSHED SEVERAL TIMES TO INITIATE THE FLOWS, AND THE OLD CHANNEL WILL BE BACKFILLED, REVEGETATED, AND IRRIGATED.
- THE LOCATIONS WHERE THE NEW ALIGNMENT AND EXISTING ALIGNMENT CONVERGE WILL BE ARMORED WITH A COMBINATION OF ROCK AND LARGE WOOD ELEMENTS. WILLOW STAKES WILL BE INCORPORATED INTO THESE ENGINEERED AREAS AND PROPAGATED SOD WILL BE PLACED AS NEEDED ON TOP OF THE ARMORED PROTECTION.
- THE NEW FLOODPLAIN, ABANDONED CHANNEL, AND ANY DISTURBED AREAS WILL BE IRRIGATED AND MONITORED FOR ONE YEAR FOLLOWING COMPLETION OF CONSTRUCTION.

DIVERSION TO RIVER MOUTH RE-CONFIGURATION (STA 9300 -10700)

- THIS YEAR THE RIVER WILL BE PUT IN THE NEW ALIGNMENT BY REMOVING THE ISOLATION BARRIER AND RE-INSTALLING IT TO ISOLATE THE OLD SECTION OF CHANNEL.
- THE NEW CHANNEL WILL BE FLUSHED SEVERAL TIMES TO INITIATE THE FLOWS, AND THE OLD CHANNEL WILL BE BACKFILLED, REVEGETATED, AND IRRIGATED.

EAST MEADOW AND APPURTENANCES

- IRRIGATION LINES WILL BE PLACED AND REVEGETATION INSPECTIONS WILL BE COMPLETED ON A MONTHLY BASIS.

YEAR 4

IRRIGATION AND VEGETATION ESTABLISHMENT OF NEW CHANNEL, EXISTING CHANNEL, AND LOWER WEST SIDE AREA (STA 6700-9300)

- IRRIGATION LINES WILL BE PLACED AND REVEGETATION INSPECTIONS WILL BE COMPLETED ON A MONTHLY BASIS.

IRRIGATION AND VEGETATION ESTABLISHMENT OF RIVER MOUTH RE-CONFIGURATION (STA 9300 -10700)

- IRRIGATION LINES WILL BE PLACED AND REVEGETATION INSPECTIONS WILL BE COMPLETED ON A MONTHLY BASIS.

EAST MEADOW AND APPURTENANCES

- INSTALL INTERPRETIVE SIGNAGE THROUGHOUT THE SITE.
- CONSTRUCT SELF-SERVE KIOSK AT THE END OF VENICE DRIVE.



UPPER TRUCKEE RIVER
AND MARSH RESTORATION
PROJECT

E.I.P. # 560



870 Emerald Bay Road, Suite 400
South Lake Tahoe, CA 96150
Tel: 530.543.5100 Fax: 530.543.5150



295 Highway 50, suite 1
Zephyr Cove, NV 89448
Tel: 775.588.9069

CONSTRUCTION
PHASING

iii

REVISIONS

#	description	date

scale:	AS SHOWN
job no.:	00110066.04
drawn by:	MC
checked by:	CM

sheet no.: iii

sheet 3 of 45
date: 01/10/13

SCHEMATIC DESIGN PLANS
& DETAILS
NOT FOR CONSTRUCTION

Legend

Existing 1000 ft. River Station

Existing 100 ft. River Station - Upper Truckee

Existing 100 ft. River Station - Trout Creek

Existing Regional Bike Trail

Proposed Habitat Features (See Sheet L-12)

Core Habitat Area

Lagoon

Restored Meadow

Restored Dune

Tahoe Yellow Cress Restricted Use Area

Proposed River and Floodplain Features

Low and Bankful Flow Channel

Partial Fill of Existing Channel

Removal of Reserve Fill

Active Floodplain

Proposed Engineered Features

Lateral Grade Control

Vertical Grade Control

Bank Protection

Bulkhead/Levee

Proposed Public Access Features

Observation Area

Viewpoint

Kiosk

Parking

Bike Path

Pedestrian Trail

Bridge

Boardwalk

0400800

Feet

0

400

800

The map illustrates the Upper Truckee River and Marsh Restoration Project, showing the river's course through various subdivisions and public access points. Key features include:

- Subdivisions:** Tahoe Island Subdivision, Tahoe Keys Subdivision, Highland Woods Subdivision, and Al Tahoe Subdivision.
- Public Access Features:** Observation Areas (3/L-7, 2/L-6), Viewpoints (3/L-3, 1/L-4, 1/L-5, 2/L-5), Kiosks (3/L-10), Parking, Bike Paths (3/L-1), Pedestrian Trails (3/L-2), Bridges (1/L-4), and Boardwalks (1/L-5, 2/L-5).
- Engineered Features:** Lateral Grade Control, Vertical Grade Control, Bank Protection, and Bulkhead/Levee.
- Habitat Features:** Core Habitat Area, Lagoon, Restored Meadow, Restored Dune, and Tahoe Yellow Cress Restricted Use Area.
- River and Floodplain Features:** Low and Bankful Flow Channel, Partial Fill of Existing Channel, Removal of Reserve Fill, and Active Floodplain.
- Elevations:** 0, 1000, 2000, 3000, 4000, 5000, 6000, 7000, 8000, 9000, 10000.
- Sheet Boundaries:** SHEET C-1, SHEET C-2, SHEET C-3, SHEET C-5.
- Other Features:** TKPOA Corporation Yard, Tahoe Keys Marina, Lower West Side Restoration Area, Cove East Beach, Barton Beach, Lakeview Avenue, Lake Tahoe, Trout Creek, U.S. Highway 50 / Lake Tahoe Boulevard, Springwood Drive, Macinaw Road, El Dorado Avenue, Placer Avenue, Capistrano Avenue, Stanford Avenue, Los Angeles Avenue, San Francisco Avenue.

DGS

CALIFORNIA TAHOE RESTORATION

UPPER TRUCKEE RIVER AND MARSH RESTORATION PROJECT

E.I.P. #560

AECOM

870 Emerald Bay Road, Suite 400
South Lake Tahoe, CA 96150
Tel: 530.543.5100 Fax: 530.543.5150

Cardno

ENTRIX

295 Highway 50, Suite 1, P.O. Box 1533
Zephyr Cove, NV 89448
Phone (775) 588-9069 Fax (775) 588-9219

ALTERNATIVE 1

CHANNEL AGGRADATION AND NARROWING
MAXIMUM RECREATION INFRASTRUCTURE

S-1

REVISIONS

#	description	date

scale :

As Noted

job no. :

00110066.04

drawn by :

EL

checked by :

CM

sheet no. : S-1

sheet 4 of 45

date : 11/07/12

➔

UPPER TRUCKEE RIVER
AND MARSH RESTORATION
PROJECT

E.I.P. # 560

AECOM

870 Emerald Bay Road, Suite 400
South Lake Tahoe, CA 96150
Tel: 530.543.5100 Fax: 530.543.5150

**Cardno
ENTRIX**

295 Highway 50, suite 1
Zephyr Cove, NV 89448
Tel: 775.588.9069

UPSTREAM REACH
PLAN
RS 0 - 3000
(ALTERNATIVE 1)

C-1

REVISIONS

#	description	date

scale: AS SHOWN

job no.: 00110066.04

drawn by: CK

checked by: CM

sheet no.: C-1

sheet 5 of 45

date: 11/20/07

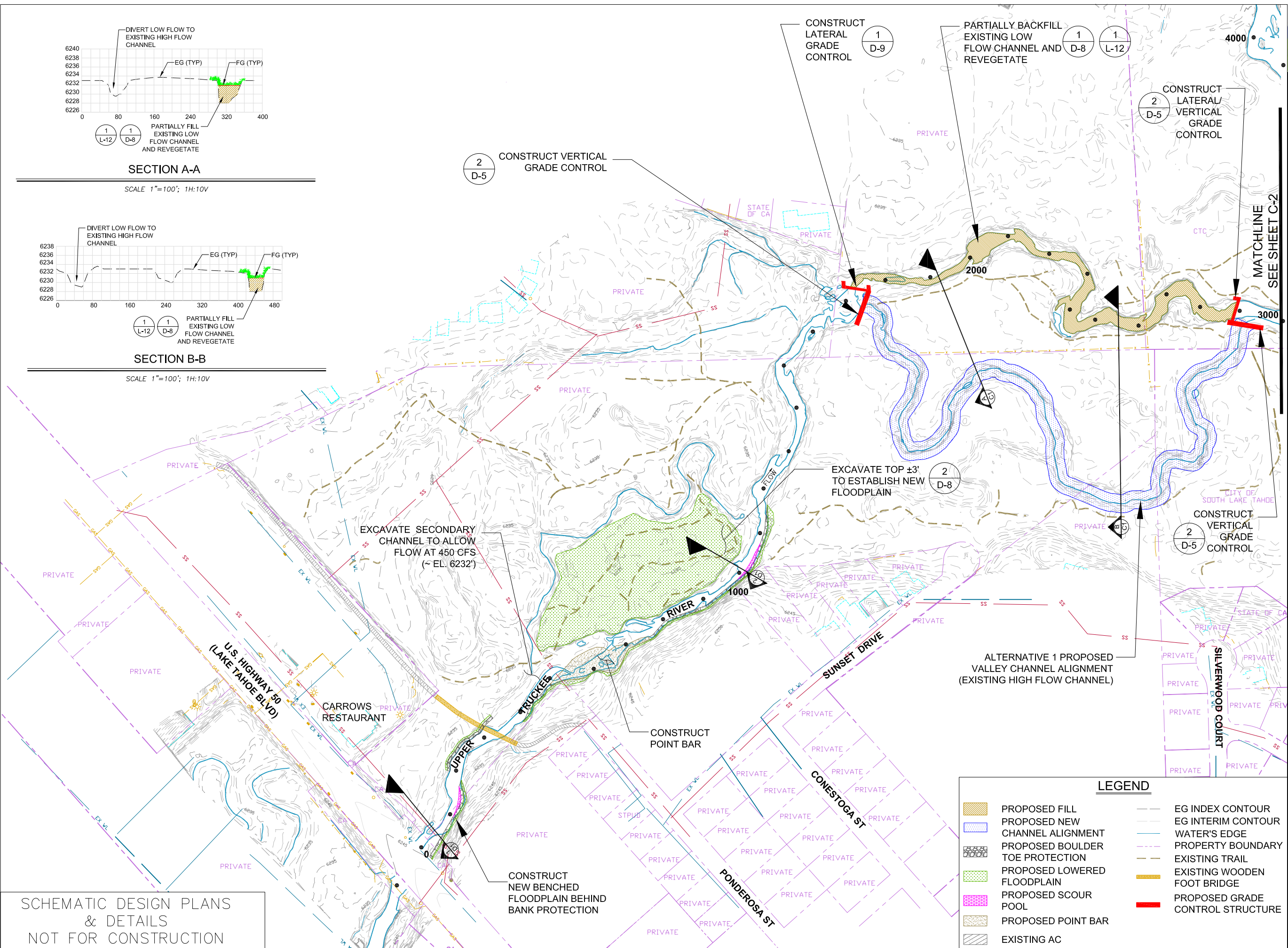
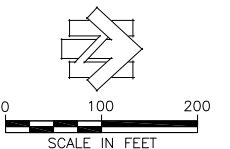

SECTION A-A

SCALE 1"=100'; 1H:10V

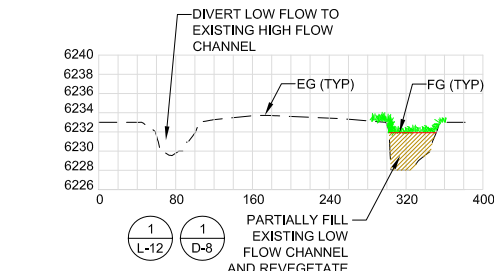

SECTION B-B

SCALE 1"=100'; 1H:10V

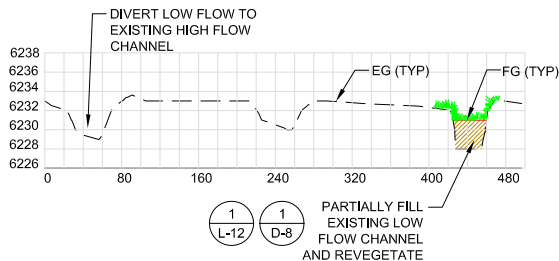

SCHEMATIC DESIGN PLANS
& DETAILS
NOT FOR CONSTRUCTION

SCHEMATIC DESIGN PLANS
& DETAILS
NOT FOR CONSTRUCTION

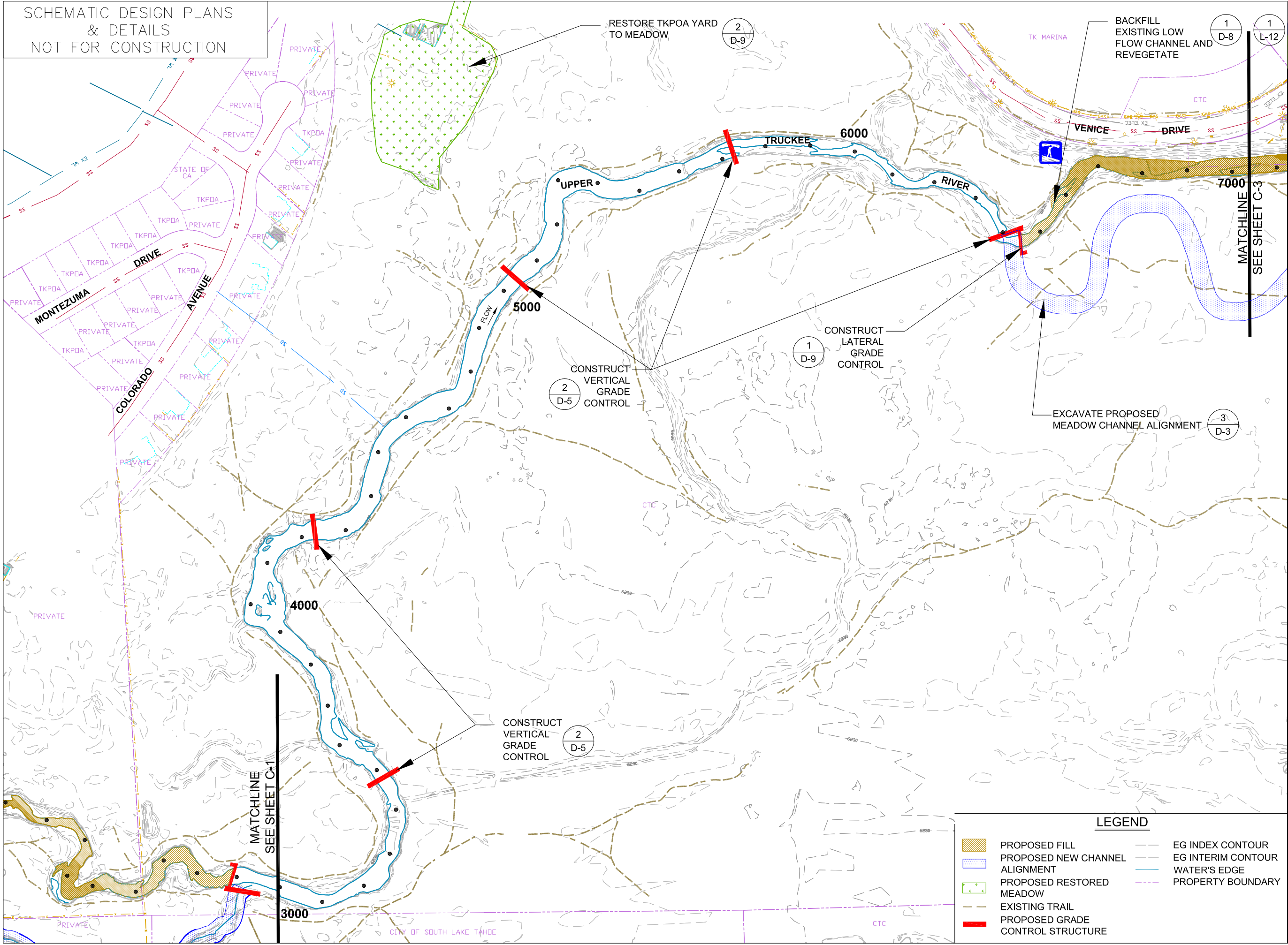

UPPER TRUCKEE RIVER
AND MARSH RESTORATION
PROJECT

E.I.P. # 560



870 Emerald Bay Road, Suite 400
South Lake Tahoe, CA 96150
Tel: 530.543.5100 Fax: 530.543.5150



295 Highway 50, suite 1
Zephyr Cove, NV 89448
Tel: 775.588.9069

MID-MARSH
PLAN
RS 3000 - 7000
(ALTERNATIVE 1)

C-2

REVISIONS

#	description	date

scale:	AS SHOWN
job no.:	00110066.04
drawn by:	CK
checked by:	CM

sheet no.: C-2

sheet 6 of 45
date: 11/20/07

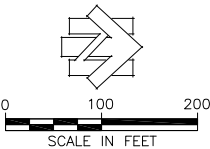

E.I.P. # 560

870 Emerald Bay Road, Suite 400
South Lake Tahoe, CA 96150
Tel: 530.543.5100 Fax: 530.543.5150

295 Highway 50, suite 1
Zephyr Cove, NV 89448
Tel: 775.588.9069

DOWNSTREAM REACH
PLAN
RS 7000 - 10100
(ALTERNATIVE 1)

C-3

[illegible]

scale: AS SHOWN

job no.: 00110066.04

drawn by: CK

checked by: CM

sheet no.: C-3

sheet 7 of 45

date: 11/20/0

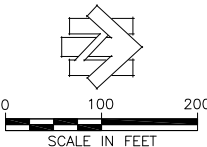

UPPER TRUCKEE RIVER
AND MARSH RESTORATION
PROJECT

E.I.P. # 560

AECOM

870 Emerald Bay Road, Suite 400
South Lake Tahoe, CA 96150
Tel: 530.543.5100 Fax: 530.543.5150

**Cardno
ENTRIX**

295 Highway 50, suite 1
Zephyr Cove, NV 89448
Tel: 775.588.9069

DOWNSTREAM REACH
RS 7000 - 10700
CROSS SECTIONS
(ALTERNATIVE 1)

C-4

REVISIONS

#	description	date

scale: AS SHOWN

job no.: 00110066.04

drawn by: CK



checked by: CM

sheet no.: C-4

sheet 8 of 45

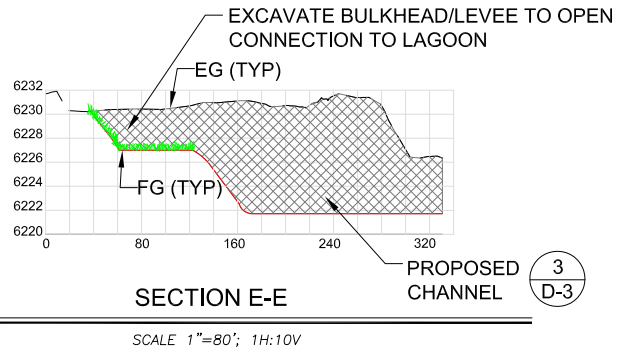
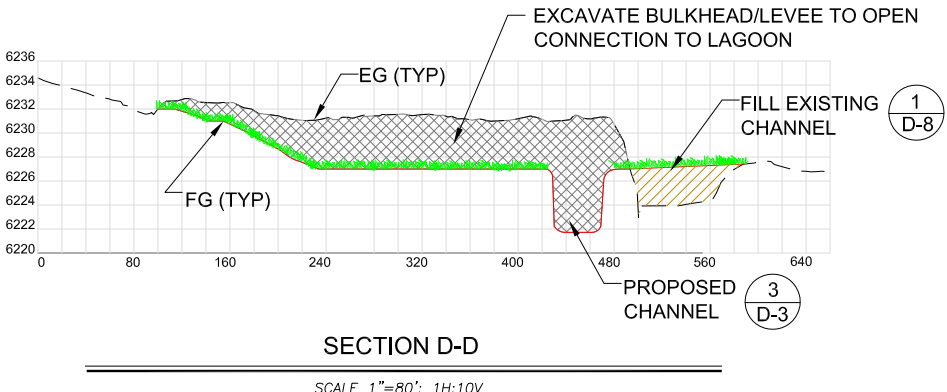
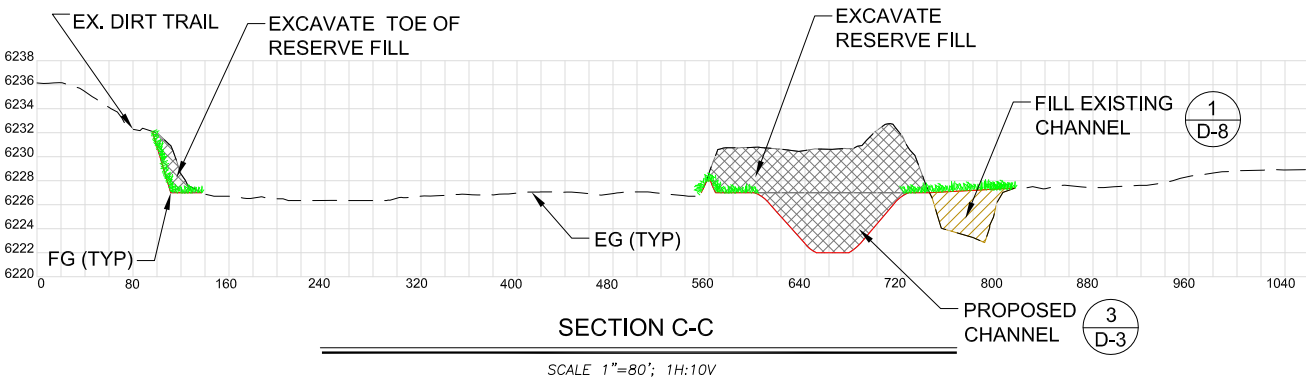
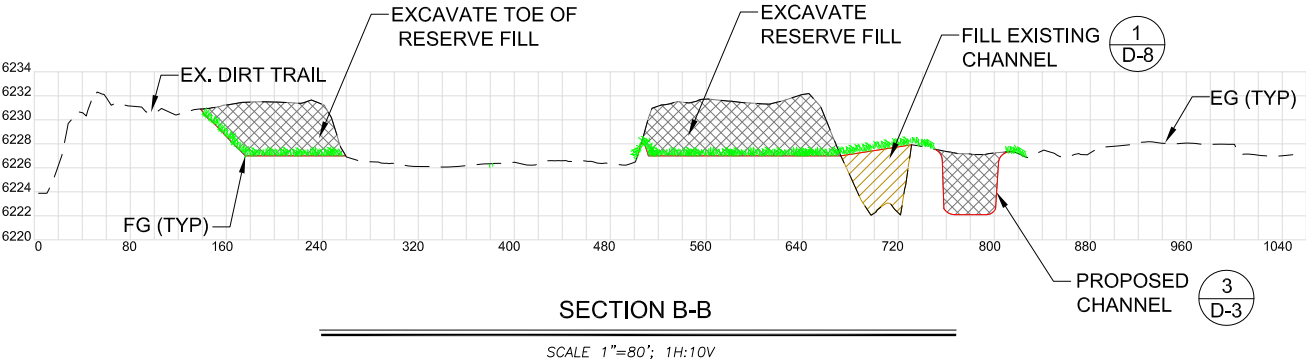
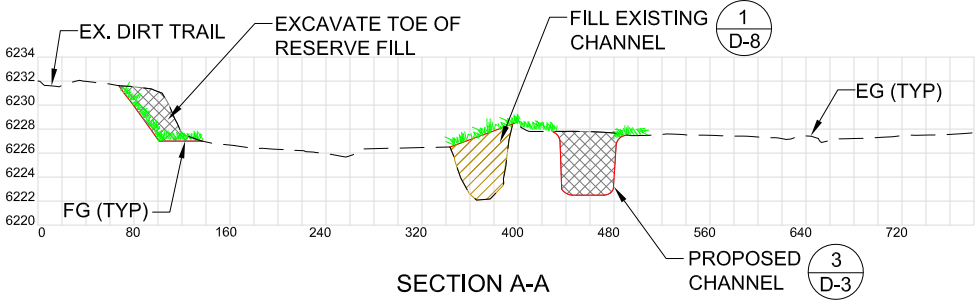
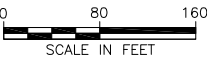
date: 11/20/07



LEGEND	
	PROPOSED CUT
	PROPOSED FILL
	PROPOSED REVEGETATION (1 L-12)

SCHEMATIC DESIGN PLANS
& DETAILS
NOT FOR CONSTRUCTION